



ALTO 2kW Fresnel and PC 2000 & 2500W

Features

Each model in the Alto range has been designed to provide a winning combination of performance and controllability to establish Alto as the obvious lighting solution for the larger venue

- ❑ Designed around 2500W CP91 lamp for increased performance
- ❑ Range comprises fresnel and PC spot
- ❑ Profile spots incorporate articulated yoke and rotating gate for enhanced controllability
- ❑ All models feature microswitch isolated lamp change system for improved safety
- ❑ Easy to use lamp adjustment on profiles
- ❑ Durable yet lightweight construction of pressure die cast and formed sheet aluminium covers



Alto F (Fresnels)

Alto F

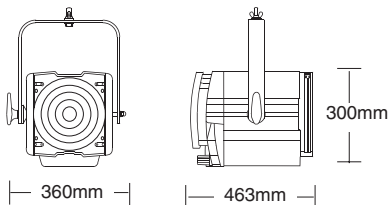

Alto PC

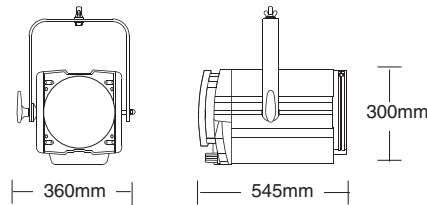

Alto PC (Prism-Convex)

Weights and dimensions

	Alto F	Alto PC
Weight	10.0kg	12.2kg
Packed Weight	12.0kg	13.0kg
Packed Volume	0.10m ³	0.11m ³



Photometric data

Typical performance based on laboratory readings using CP91 2500W lamp

Alto F: Spot

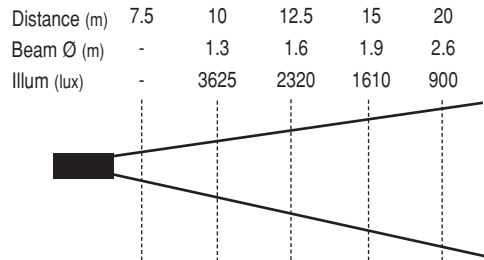

Alto F: Flood

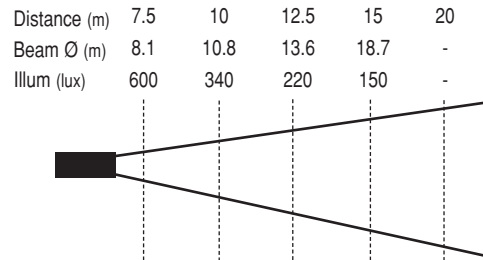

Alto PC: Spot

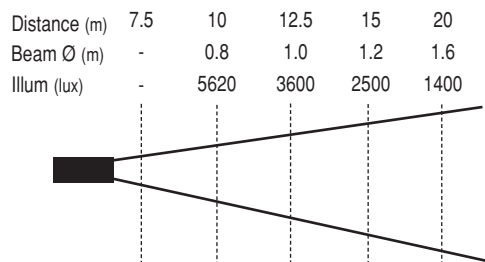

Alto PC: Flood

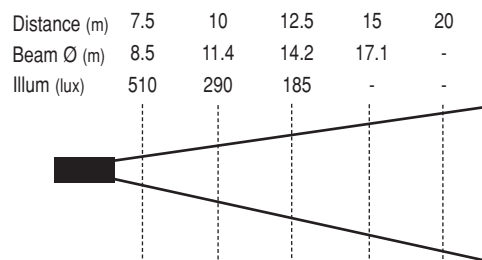

To calculate lux levels at any throw distance divide the following factors by the distance squared:

	Alto F	Alto PC
Spot/Narrow	362670	561900
Flood/Wide	34240	28860

e.g. Alto PC at full flood over 12m throw $28860/144 = 200\text{Lux}$

To calculate beam diameters at any throw distance multiply the throw in metres by the following factors:

	Alto F	Alto PC
Spot/Narrow	0.13	0.08
Flood/Wide	1.25	1.14

e.g. Alto PC at full flood over 12m throw $1.14 \times 12 = 13.68\text{m}$



Operational features

Lamp Access

Rear catch releases drop down lower covers to give access to slide down lampholder assembly. Power is disconnected when lower covers open.

Focus Adjustment

F & PC:

By rotary control on front and rear of lamphouse

Lamp Adjustment

Beam distribution on profiles adjusted by rotary control on rear of lamphouse. Lamp alignment adjusted by screwdriver on rear panel.

Ordering information

Alto F & PC are supplied complete with 1.5m and Alto profiles with 3m of 2.5mm² cable terminated with fitted plug. All Alto spotlights are also supplied with metal colour frame and CP92 2000W lamp. 240V models come with 15A plug and 240V lamp. 230V models come with Schuko connector and 230V lamp.

Cat No	Description	Optional accessories & replacement lamps
12200	Alto F Mk2	19112 Barndoor, 4 leaf rotatable
12210	Alto PC Mk2	18202 Gobo Holder for "A" size gobos
		18201 Iris, 18 leaf
		82011 Hook Clamp, heavy duty
		82001 Safety cable, heavy duty
		55001 Colour Call Scroller CC1
		18203 Additional colour frame, metal

Accessories

Alto Mk2 F & PC accept a new four leaf rotating barndoor which will also fit Mk1 models. Alto profiles incorporate runners to accept a gobo holder for "A" size gobos or an 18-leaf iris. All Alto spotlights have colour runners to take DIN standard 245 x 245 mm colour frames.

Mechanical/Electrical Data

Construction

Pressure die cast front and rear panels with extruded aluminium tie bars and formed aluminium cover panels all finished in two tone grey and black epoxy powder coating.

Gate/Lenstube

Pressure die cast gate assembly is rotatable through 220 and houses four removable beam shaping shutters and runners for gobo holder or iris.

Lenses

Heat resistant borosilicate lenses. F & PC lenses mounted in die cast front panel behind 25mm wire guard.

Lampholder

G22 to take lamps of 90 mm LCL and maximum of 2500W

Supply Voltage

230V +/- 10% 50/60 Hz

Standards compliance

Designed to conform to EN 60 598 2-17

Strand Lighting Ltd

Unit 3 Hammersmith Studios, Yeldham Road,
Hammersmith, London W6 8JF United Kingdom
Tel: +44 (020) 8735 9790
Fax +44 (020) 8735 9799

Strand Lighting GmbH

Ullsteinstrasse 114-142 D-12109
Berlin, Germany
Tel: +49 (0) 30/70 79 51 0
Fax: +49 (0) 30/70 79 519 9

Strand Lighting Italia srl

Via delle Gardenie 33 00040
Pomezia-Roma, Italy
Tel: +39 06 919631
Fax: +39 06 9147136

Strand Lighting Asia

20/F Delta House, 3 On Yiu Street
Shatin, N.T. Hong Kong
Tel: (852) 2757 3033
Fax: (852) 2757 1767



The Company reserves the right to make any variation in design or construction to the equipment described.
© Strand Lighting Ltd. 2002
Strand™, Strand Lighting™, Strand Quartzcolor™ are trademarks of Strand Lighting Limited and Strand Lighting Inc.